



 **combirex**

PNEUMATIC TENSION BRAKE



combirex

CX250

Combirex CX 250 pneumatic brake has been the reference brake in the converting industry and it is still widely used on unwinders and various applications.

The CX 250 is the most copied pneumatic brake in the world, but you should know that it has been designed by Giampiero Re in the '80s, the same person who founded Renova in 2005.

Mr Re then applied an innovative axial fan ventilation on the CX mono disc brakes, which increased the cooling speed, reducing pad wear and improving web tension quality, compared to previous brakes with no cooling fan.

Today, the Renova's CX pneumatic brake is the result of continuous research and improvements. Great care is taken to select the best materials in order to provide always the highest performance and reduce component's wear

Click on the "play" icons in this catalog and see demonstration videos!



MONODISC BRAKE

The combirex CX250 is a monodisc, multicaliper air cooled brake. It reaches a maximum torque of 708 ft-lbf and a power dissipation of 6 hp.

LIGHT COMPACT STRUCTURE

aluminium housing of compact size

MODULAR CALIPER SYSTEM

on/off distributor for a manual selection of the calipers

HIGH POWER DISSIPATION FAN

high RPM fan up to 6 hp

COMBIREX

The combirex CX250 is available with up to 6 calipers according to the torque needed. Moreover a selection of diverse HP fan models is available in order to reach different heat dissipation values.

TECHNICAL DATA

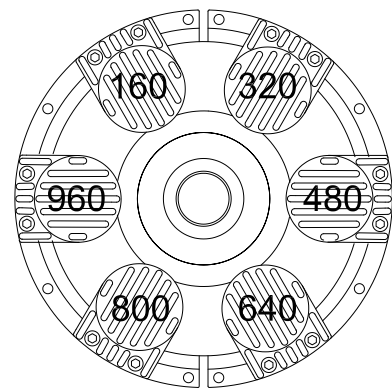
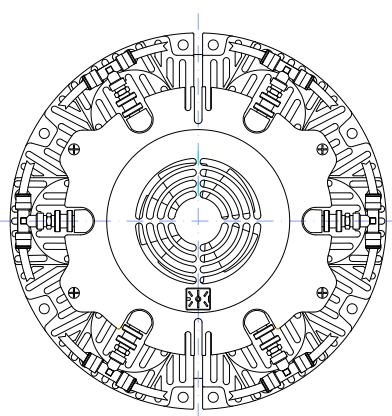
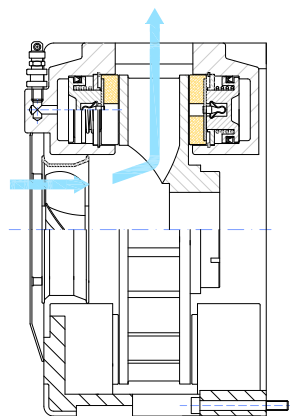

	CX 250.1	CX 250.2	CX 250.3	CX 250.4	CX 250.5	CX 250.6
number of calipers	1	2	3	4	5	6
torque ft·lbs (3 psi)	1.1	2.2	3.3	4.4	5.5	6.6
torque ft·lbs (87 psi)	118	236	354	472	590	708
heat dissipation (fan 24 VdC HP1)	5 hp	5 hp	5 hp	5 hp	5 hp	5 hp
heat dissipation (fan 24 VdC HP2)	5.5 hp	5.5 hp	5.5 hp	5.5 hp	5.5 hp	5.5 hp
heat dissipation (fan 24 VdC HP3)	6 hp	6 hp	6 hp	6 hp	6 hp	6 hp

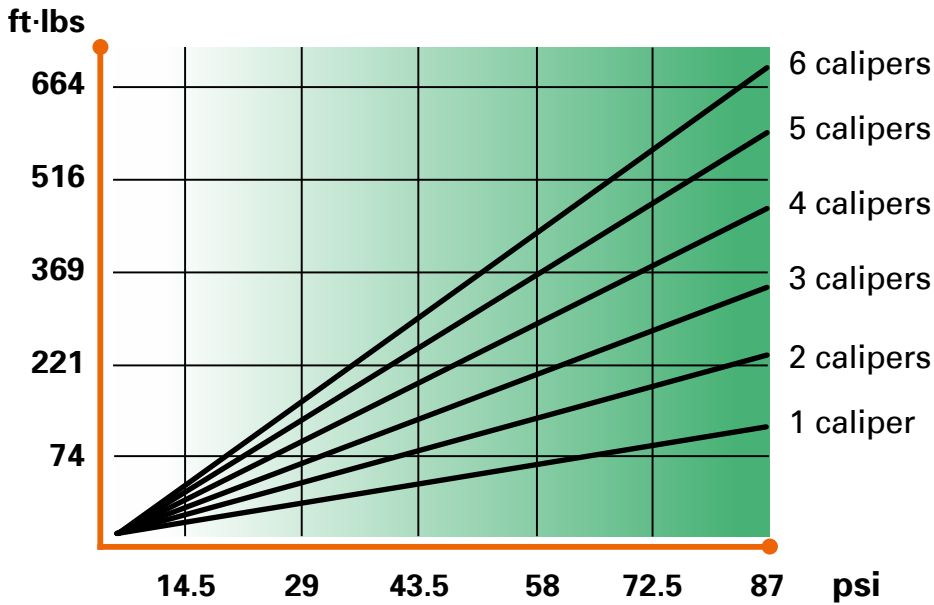

COMBIREX SPARE PARTS



100% INTERCHANGEABLE

A wide range of original spare parts for combirex CX250 that are also 100% interchangeable and suitable for all the brakes series CX250 is available on the market.

PADS

Thanks to the new compounds formula, Renova’s pads guarantee a longer life and therefore a reduced need for spare parts and reduced dust emissions in the workplace.



ROHS compliant: all pads are asbestos, hexavalent chromium, mercury, cadmium, antimony and lead FREE!

SMT



description	code
smooth pads	KPCXSMT
smooth pads with anti-vibration ring	KPCXSMTA

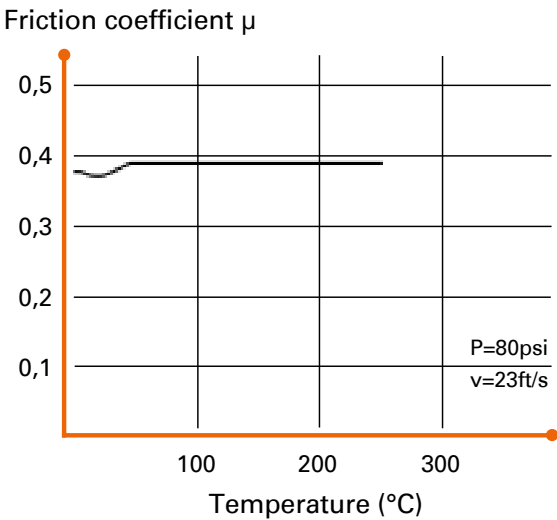

AR15



description	code
anti-rotation pads	KPCXAR15
anti-rotation pads with anti-vibration ring	KPCXAR15A

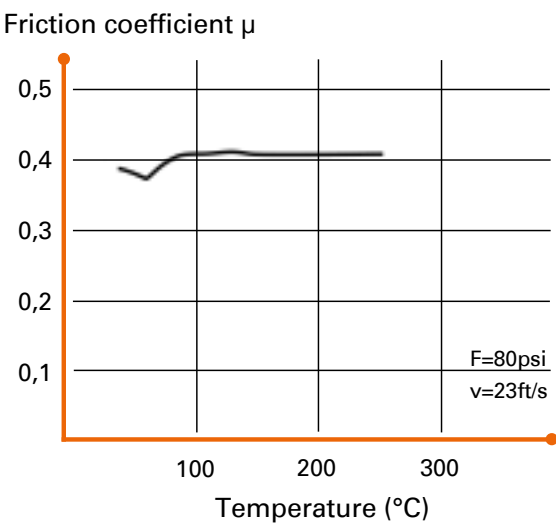

AR15K



description	code
anti-rotation pads in kevlar material	KPCXAR15K
anti-rotation pads in kevlar material with anti-vibration ring	KPCXAR15KA

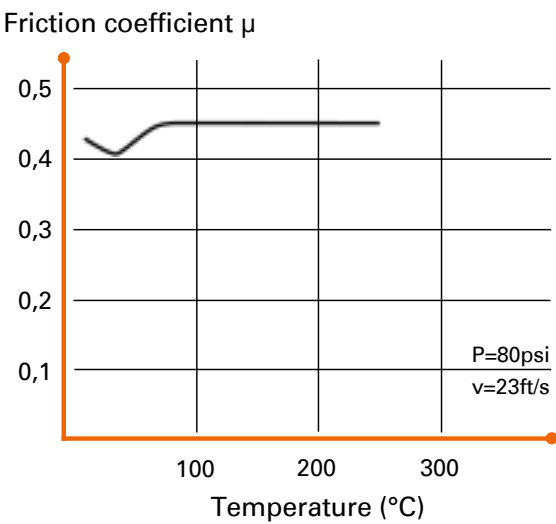

HP



description	code
anti-rotation pads high performance	KPCXR15HP
anti-rotation pads high performance with anti-vibration ring	KPCXR15KHPA

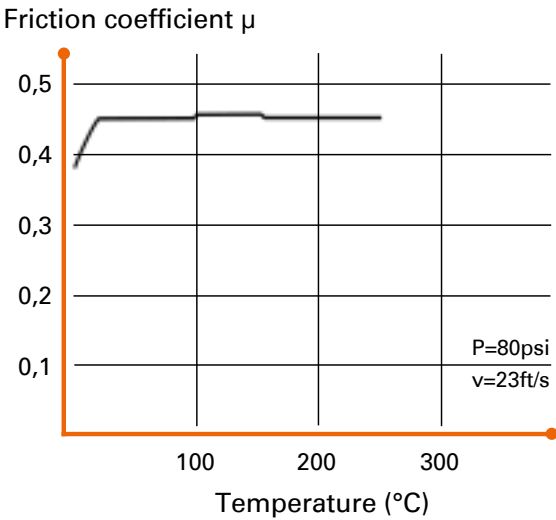

DISCS



SELF-VENTILATING STURDY DISC

the self ventilating cast iron 9.8" diameter disc improves the cooling capacity by rapidly conveying outwards the heat generated by the brake

CONSTANT TENSION CONTROL

high sensitivity throughout the whole process

description	code	hole diameter	fixing type	notches
standard (hole diameter Ø1.2")	CXD250	000	0	0
modular code	CXD250	DXX	X	X
	CXD250	D28 (1.1")	C (with taper locks)	0-24
		D30 (1.2")		
		D35 (1.4")		
		D40 (1,6")		
		D45 (1.8")		
		D35 (1.4")	Z (with keyway and set screw*)	
		D40 (1.6")		
		D45 (1.8")		
		D50 (2.0")		
		D55 (2.2")		
		D60 (2.4")		
		D65 (2.6")		
		D70 (2.8")		

*standard screw is M10, other dimensions on request

CALIPERS

number	description	code
1-9	complete caliper without pads	CXC0000
1	air distributor (1/8" GAS)	00CXDIS610-G18-R20
2	front caliper frame (1/8" GAS)	CXP0002
3	back caliper frame	CXP0003
4	spring	CXP0004
5	teflon ring	CXP0005
6	seeger ring	CXP0006
7	viton seal dem 63	CXP0007
8	piston	CXP0019
9	pad seal spring	CXP0009
10	pad	SMT / AR15 / AR15K / HP
11	rapid fitting elbow	I40-0048
12	rapid fitting tee	I40-0049
pad	complete caliper with pad	complete caliper with anti vibration pad
AR15	CXC0010	CXC001A
HP	CXC0020	CXC002A
SMT	CXC0030	CXC003A
AR15K	CXC0040	CXC004A

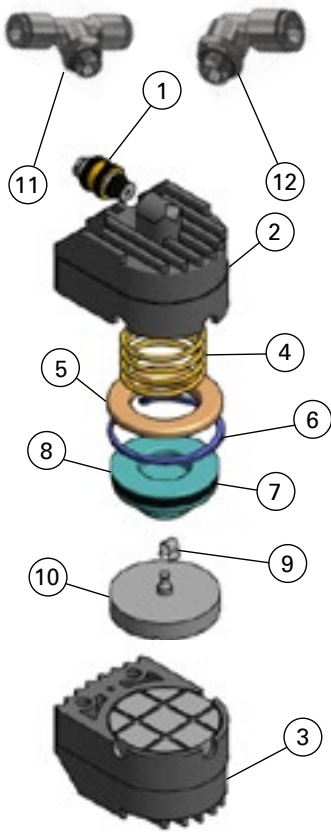

FANS

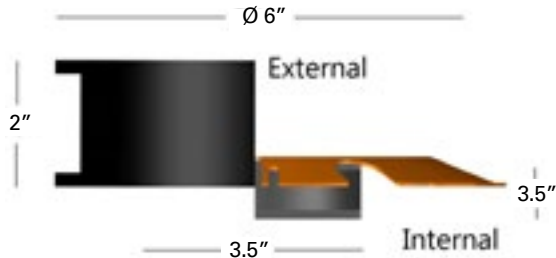

Upgrade kit fan cover plus fan:

description	code
KIT HP1 (fan cover + internal 24 VdC HP1)	CXK0001-A
KIT HP2 (fan cover + internal 24 VdC HP2)	CXK0002-A
KIT HP3 (fan cover + internal 24 VdC HP3)	CXK0003-A

OPTIONALS AND ACCESSORIES

RPM COUNTER (PROXIMITY)

It counts the revolutions per minute to identify the diameter of the roll.

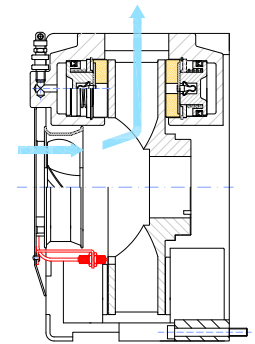

TAPER LOCKS

Wide range of taper locks available for a rapid fixing to the hub.

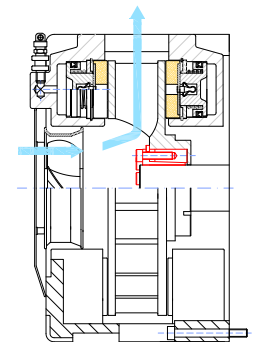

ROTARY JOINT

In case of application with expanding shaft or pneumatic core chucks. It allows the transit of the air supply to the shaft or the chuck.

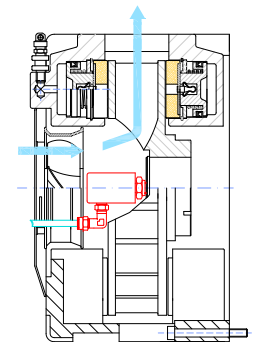

PHOTOCELL SUPPORT

Photocell set up for roll stand arm alignment.



BRAKE SELECTION GUIDE

	unit of measurement		tensioning
t	braking time [s]	$T_{max} = T_s \cdot L_{max}$	maximum web tension
v	web speed [ft/min]	$T_{min} = T_s \cdot L_{min}$	minimum web tension
T _{max/min}	max/min web tension [lbf]	$C_{fmax} = \frac{D_{max} \cdot T_{max} \cdot 0.083}{2}$	maximum torque
D _{max/min}	max/min roll diameter [in]	$C_{fmin} = \frac{D_{min} \cdot T_{min} \cdot 0.083}{2}$	minimum torque
P	heat dissipated [hp]	$P = \frac{T_{max} \cdot v}{60 \cdot 10^3}$	heat dissipated
m	roll maximum weight [lb]		
T _s	web tension per centimeter [pli]		
L _{max/min}	max/min web width [in]		
		$C_{fmax} = \frac{m \cdot D_{max} \cdot v}{92664.67 \cdot t}$	emergency stop torque

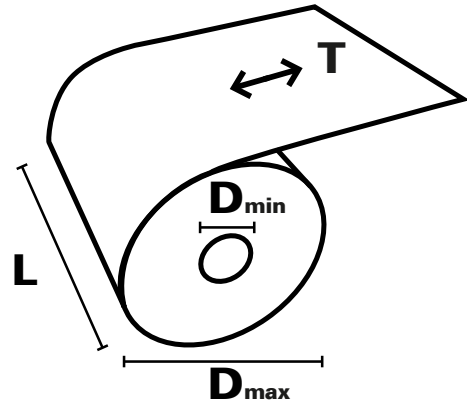

SPECIFIC TENSION VALUES FOR MATERIALS

	paper			board		
Basic weight [lb]	6.8 - 10.1	20.3 - 40.5	67.6 - 135.1	67.6 - 101.4	135.1 - 202.7	270.3 - 473.0
web tension [lbf] per linear inch (T _s)	0.17 - 0.23	0.57 - 1.43	2.0 - 4.0	2.86 - 4.28	5.71 - 6.57	6.57 - 10.28
	cellophane	polythylene	polypropylene	aluminum		
pli per μ of thickness	0.02	0.006- 0.011	0.009 - 0.014	0.02 - 0.07		

QUESTIONNAIRE



Please fill out the questionnaire, take a picture and send it via email to info@renova-srl.com

CUSTOMER

complete
name
position
company
plant
country
tel
email

APPLICATION DATA

machine type
application
n° brakes per roll 1 2
fans voltage 110 AC
220 AC
24 VDC
brakes pressure bar
roll diameter min in
max in
roll width min in
max in
roll weight min lb
max lb
speed min ft/min
max ft/min
type of material lb
emergency stop sec

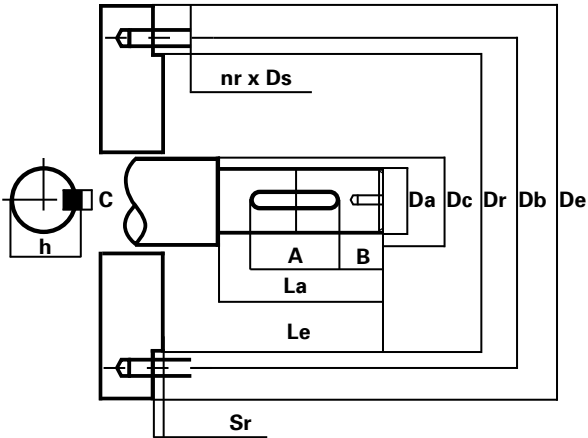

FLANGE DIMENSION

external diameter (De) in
centering diameter (Dr) in
centering thickness (Sr) in
holes position diameter (Db) in
nr per Ø of holes (nr x DS)
angles between holes (b°)

SHAFT DIMENSION

shaft diameter (Da) in
shaft length (La) in
shaft diameter (Dc) in
total length (Le) in
key dimensions (C x h) in
blocking system seeger
bolt
threaded ring
dimension for hub/disc A in
B in



MADE IN ITALY
Our products are 100% designed and made in Italy

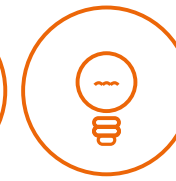

SUPPORT
Our staff is always available to answer your questions also in the after sales phase



CUSTOM PROJECTS
Project large or small, we work with you to provide the solution that fits

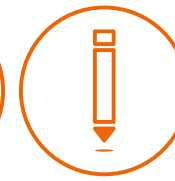

INNOVATION
We provide solutions that increase the productivity and the safety level while reducing maintenance costs and procedures

QUALITY
All Renova's products are managed by TUV ISO 9001



SUSTAINABILITY
Sustainable products, sustainable company. Renova has joined Erion



renova
WE NEVER LOSE CONTROL



Authorized US Distributor

1590 N Roberts Rd #201, 30144 Kennesaw, GA - USA
sales@cstsystems.net | www.cstsystems.net

 **renova**
WE NEVER LOSE CONTROL

 **renova**
WE NEVER LOSE CONTROL

renova srl
viale rimembranze 93
20099 sesto san giovanni
milano - Italy

t +39 022700739
f +39 0225708635
m info@renova-srl.com

www.renova-srl.com



 **combirex**

PNEUMATIC TENSION BRAKE